

100mm (A1), 50mm (A3)
page scale

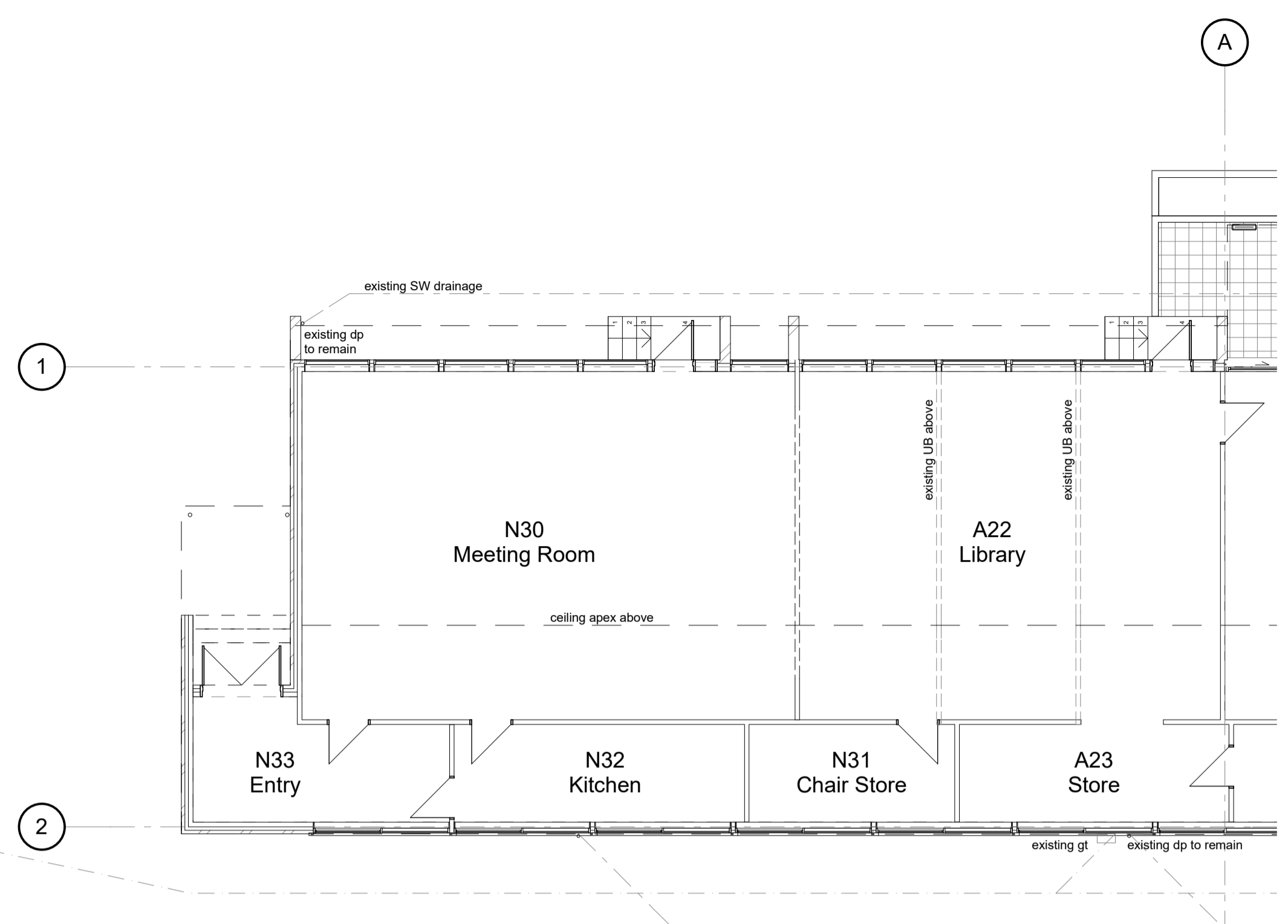

DRAFT ONLY

DRAFT ONLY

DRAFT ONLY

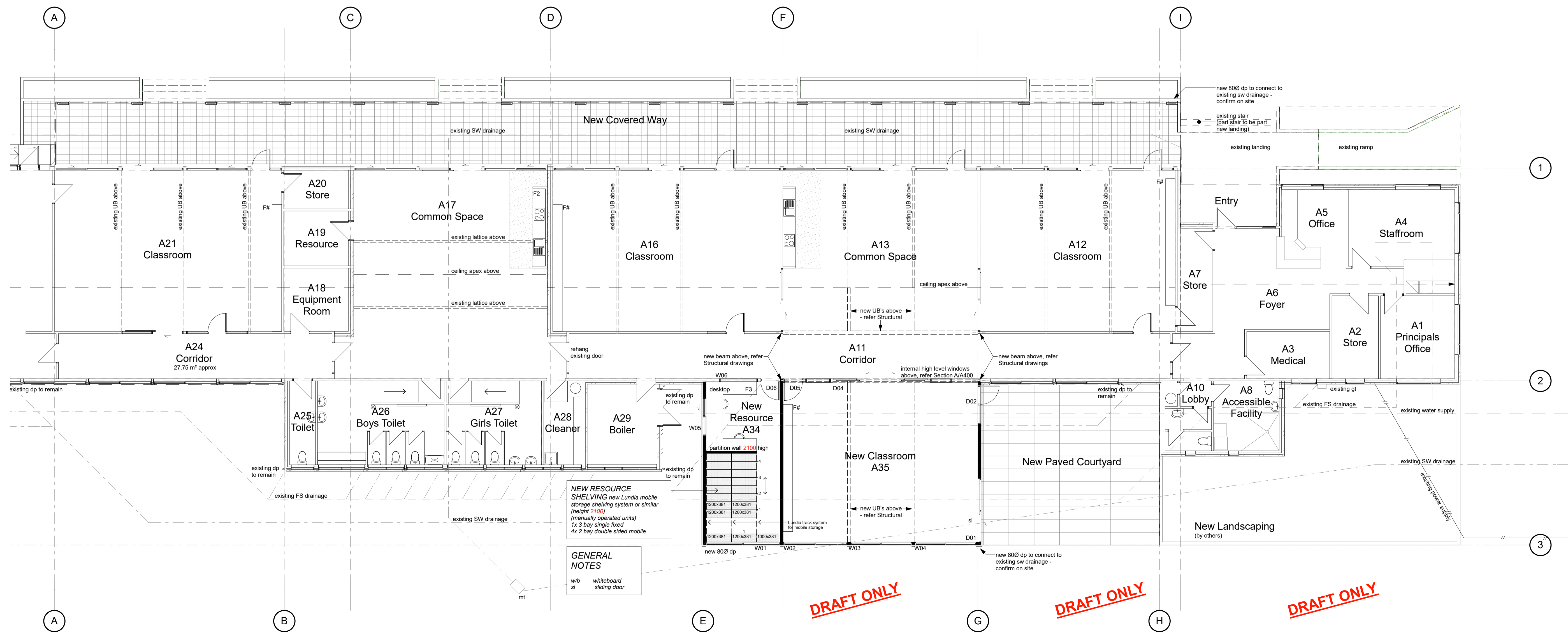

DRAFT ONLY

no.	chID	revision	date
All dimensions to be checked on site. Do not scale off these drawings. Any discrepancies between drawings to be notified to the consultants.			

consultants



St THOMAS SCHOOL, WINTON

Proposed Floor Plan

DRAFT ONLY

scale 1:100 @ A1, 1:200 @ A3
 project number 5318
 printed 6/06/2019 5:15 PM
 status **PRELIMINARY**

McCoy Wixon ARCHITECTS

242 Stuart St, PO Box 5456 DUNEDIN
 T 03 477 2000
 F arch@mc coywixon.co.nz
 W mc coywixon.co.nz

A202

NEW RESOURCE SHELIVING new Lundia mobile storage shelving system or similar (height 2100)
 1x 3 bay single fixed
 4x 2 bay double sided mobile

GENERAL NOTES
 wb whiteboard
 sl sliding door

DRAFT ONLY

DRAFT ONLY

DRAFT ONLY